

# Cost-Effective Free-Standing Foam Board Backdrop (Disposable)

This cost-effective foam board backdrop is constructed using foam board with two support stands at the back. A single 8 x 8 ft matte print is affixed onto two foam panels, giving it the illusion of a sturdy wooden structure while keeping costs low.

### Highlights

- Lightweight & Disposable – Can be easily broken down into smaller sections for disposal by you or venue staff.
- Budget-Friendly – The most economical option, eliminating extra dismantling charges.
- Customizable – Available in various shapes and sizes upon request.



AL PRINTING SERVICES

# Backdrop Pole Banner Stand

## Available sizes:

- Backdrop stand 2m Wide x 2m Height
- Backdrop stand 3m Wide x 2m Height



### Installation

Quick Installation and no extra tool needed to set up.



### Easiest

Can be easily transported and set up instantly to form a backdrop.



### Perfect

Lightweight and strong aluminium pole.

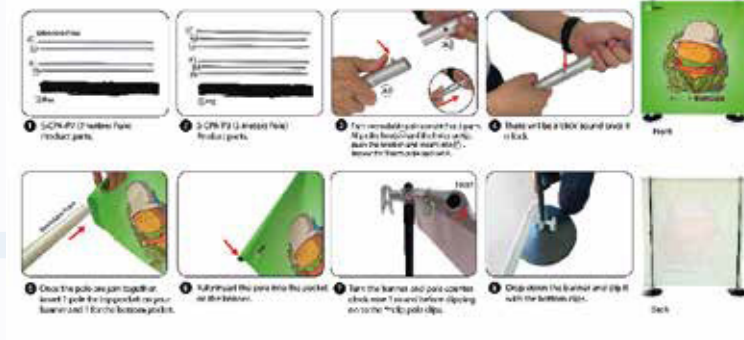

Quick Installation and no extra tool needed to set up.



Can be easily transported and set up instantly to form a backdrop.



Lightweight and strong aluminium pole.

# Wooden Backdrop

Wooden backdrops are perfect for stages, events, or road shows that need a professional look for one-time use. Custom sizes are available, with options to include TV or projector screen mounting. No job is too big or small— we handle all projects. Choose from vinyl stickers or budget-friendly PVC canvas prints for your backdrop.



# Pop Up Fabric System

The 14 kg Pop Up Display System is faster and lighter than traditional magnetic displays, offering a simple, quick setup. Just open the frame, install the printed graphics on non-reflective fabric, and you're ready to showcase your message. It's the perfect solution for trade shows, roadshows, exhibitions, and retail spaces, providing an easy way to promote your products or services.

- **Faster & Lighter:** Weighs only 14 kg, lighter than traditional magnetic displays.
- **Quick & Simple Setup:** Open the frame, install non-reflective fabric graphics, and you're ready to go.
- **Compact & Portable:** Takes up only 32 cm of space, saving time, energy, and money.
- **No Heavy Magnets or Panels:** Uses Velcro fabric instead, making it lighter (around 2.1 kg).
- **Wind-Resistant:** Fabric reduces wind resistance, making it ideal for outdoor use.
- **Easy Assembly:** No complicated panel fittings; creases can be easily adjusted.
- **Cost-Effective:** No need for heavy, reflective displays or expensive hard cases.
- **Available sizes :** 3x3, 4x3, 6x3, 8x3



6 x 3



8 x 3

AL PRINTING SERVICES

# LUCID Mobile Light Box (With Double-sided Print)

## Important Notes:

- The material is slightly stretchy.
- Measurements provided reflect the visible size.
- Store prints in a rolled format when not in use.
- Wrinkles and creases may occur in the print due to packaging.
- Tightening the prints during setup will result in a wrinkle-free finish.
- Avoid folding the fabric, as it will damage the print.
- Darker colors may flake, causing white spots.
- White spots will be covered with a permanent marker.

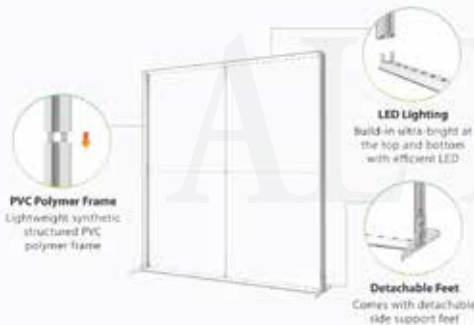

### No Loose Wires

Built in electrical wiring so there are no internal loose wires to connect.

### Adjustable Height

One frame can be built to 2.25 meter or 2 meter height, just add or remove the center upright piece.

### Edge to Edge Display

Silicon Edge Graphics create a perfect edge to edge Light Box Backdrop panel.

### Double Sided Showcase

Double-sided graphics for use in road show, exhibition and all kind of events as a backlit display.

### Contents

- 1 x Set of PVC Polymer frame Profiles
- 2 x Pieces of PVC Fabric (135D) printing
- 1 x Piece of Padded Black Canvas bag
- Product Weight: 22.05kg



## Available Sizes:

### 1000mm x 2250mm Size Guide

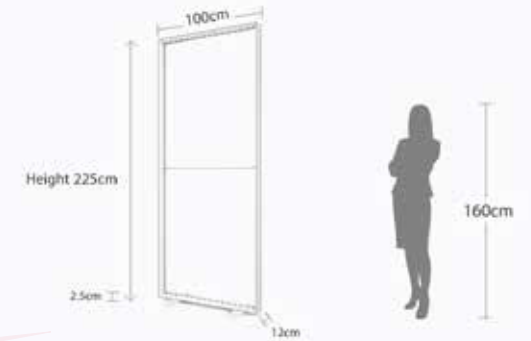

### 2000mm x 2250mm Size Guide

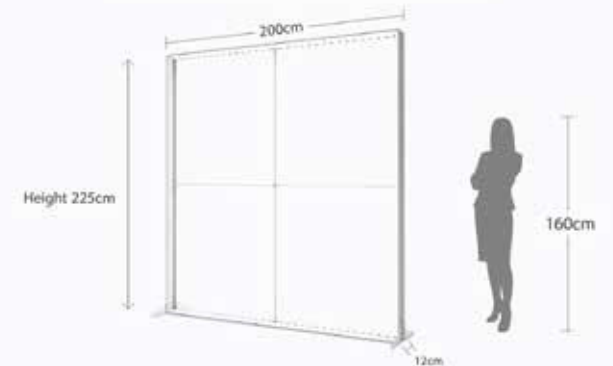

### 3000mm x 2250mm Size Guide

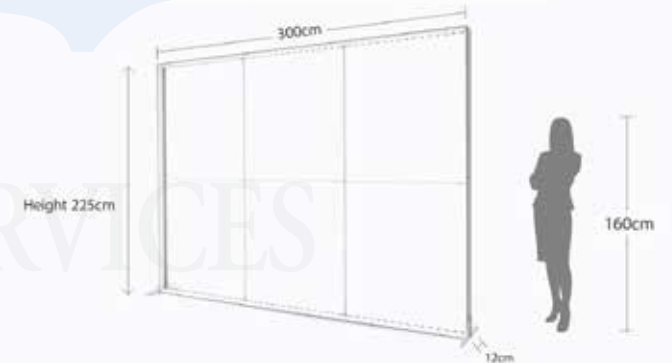

# Economy Adjustable Tradeshow banner display stands

The Adjustable Tradeshow display helps you create a perfect photo backdrop. With this, you can promote your brand and business to the next level. Our Adjustable Tradeshow display banners are ideal for movie premieres, new product launch events, birthday parties or anywhere you want your logo front and center.

## Fabric

Our straight tension fabric display is made from durable materials, including 250g soft knitted polyester fabric. The fabric Light in weight & budget-saving, Good for both indoor and outdoor uses.

## Printing

High-Quality Printing for Your Outstanding Display

Your gorgeous graphics will be printed on the fabric with dye sublimation printing or digital printing, which depends on the material you choose. Professional artwork design and quality printing will give you a stunning advertising display.

## Hardware

Premium Display Hardware and Accessories

The frame of Adjustable Tradeshow display banners is made of high quality, lightweight aluminum for maximum durability and portability. The item is excellent for the backdrop display. Adjustable Tradeshow display banners sets up in minutes and is a great way to boost your brand exposure.

## Fabric Care

All our fabrics are washable with cold water and mild detergent. After washing, please use air dry or iron dry it at low setting. The life span of the display products depends on both display and storage situations. Before storage, please make sure the whole piece is light and dry.



# Trade show Straight tension fabric display backdrop

Elevate your brand's visibility with the Straight Tension Fabric Display. Introducing the Straight Tension Fabric Display, the latest advancement in our line of high-quality display products. Fully upgraded based on our traditional tension fabric display, this new version combines an enhanced design and display with premium quality materials, all at competitive pricing.

## SPECIFICATIONS

Size	Graphic Size(mm)	Frame Size(mm)	Tube Dia	Base Length	Base Width	Packing
8ft	2440x2210	2400x2200	32mm	480mm	80mm	28x28x82cm weight:6.5KG
10f	2990x2210	2950x2200	32mm	480mm	80mm	28x28x82cm weight:7.5KG
20ft	5940x2210	5900x2200	32mm	480mm	80mm	38x38x82cm weight:11KG

## Straight Tension Fabric Display: Revolutionizing Trade Show Presence

Building on the success of our traditional tension fabric displays, the Straight Tension Fabric Display incorporates numerous improvements for better functionality and aesthetics. The streamlined structure ensures a sleek, modern look that draws attention.

The upgraded design provides a more robust and visually appealing display. Perfect for trade shows, conferences, and promotional events, this display ensures your message stands out in any setting.

## FEATURES

**Custom Engineered-** Our frame is meticulously designed and developed in-house, ensuring a perfect fit and superior quality tailored specifically for our tension fabric displays.

**Competitive Pricing-** Despite the enhanced features and premium materials, the Straight Tension Fabric Display is priced competitively.

**Double-Sided Display Option-** Choose the double-sided display feature to maximize your branding and visibility from multiple angles.

**Versatile Use-** Perfect for indoor events, including trade shows, conferences, retail displays, and promotional events.

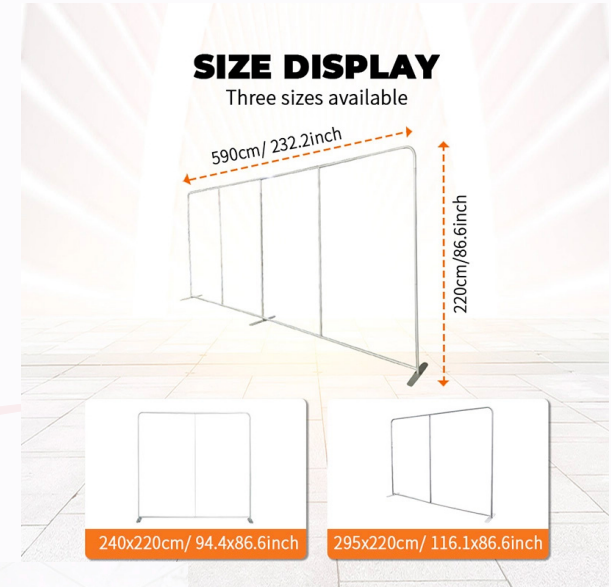

# Tradeshow Curve Tension Fabric Display Backdrop

## Unveiling the Ultimate Display Solution: Tradeshow Curve Tension Fabric Display Backdrop

Introducing the Tradeshow Curve Tension Fabric Display Backdrop, a perfect blend of innovative design and high-quality materials tailored for impactful visual presentations. This display is designed to provide a sleek, modern, and eye-catching backdrop for any event, ensuring your brand stands out.

### SPECIFICATIONS

Size	Graphic Size(mm)	Frame Size(mm)	Tube Dia	Packing
8ft	2320x2210	2280x2200	32mm	28x28x82cm weight:5.5KG
10f	3040x2210	3000x2200	32mm	28x28x82cm weight:6.5KG
18ft	5460x2210	5450x2200	32mm	38x38x82cm weight:10KG

### DETAILS

## Elevate Your Brand with Vimbo's Upgraded Tradeshow Curve Tension Fabric Display Backdrop

Upgraded to higher-quality tubing and framing for increased strength and durability. The larger diameter round pipes provide additional stability and support for the display. The dimensions of the feet have been enlarged to offer greater stability and strength, ensuring the display remains secure even in high-traffic areas.

Crafted from high-quality tension fabric, the display offers exceptional durability and longevity. The fabric graphics are printed in high resolution with vibrant, fade-resistant colors. The elegant curved structure of the display creates a dynamic and inviting presentation, drawing attention and enhancing the visual appeal of your booth or exhibit.

### FEATURES

**Enhanced Tubing and Framing** - Upgraded to higher-quality tubing and framing, providing increased strength and durability for long-lasting use.

**Larger Diameter Pipes** - The larger diameter round pipes offer additional stability and support, ensuring the display remains secure and upright.

**Interchangeable Graphics** - Easily update your display with new graphics as needed. The fabric is designed to be removed and replaced effortlessly, making it versatile for different events and promotions.

**Comprehensive Support** - Comes with detailed instructions and customer support to assist with any assembly or usage questions.

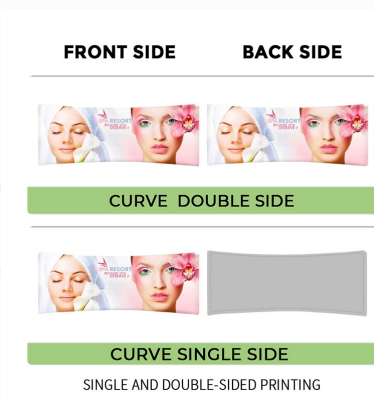

# U-Shape Exhibition Tension Fabric Display Backdrop

## Unveiling the Ultimate Display Solution: U-Shape Exhibition Tension Fabric Display Backdrop

Introducing the U-Shape Exhibition Tension Fabric Display Backdrop, a perfect blend of innovative design and high-quality materials tailored for impactful visual presentations. This display is designed to provide a sleek, modern, and eye-catching backdrop for any event, ensuring your brand stands out.

### SPECIFICATIONS

Size	Graphic Size(mm)	Frame Size(mm)	Tube Dia	Packing
8ft	2440x2280	2400x2270	32mm	28x28x82cm weight:6.5KG
10f	3040x2280	3000x2270	32mm	28x28x82cm weight:7.5KG
20ft	6040x2280	6000x2270	32mm	38x38x82cm weight:12KG

### DETAILS

#### Elevate Your Brand with Vimbo's Upgraded U-Shape Exhibition Tension Fabric Display Backdrop

Upgraded to higher-quality tubing and framing for increased strength and durability. The larger diameter round pipes provide additional stability and support for the display. The dimensions of the feet have been enlarged to offer greater stability and strength, ensuring the display remains secure even in high-traffic areas.

Crafted from high-quality tension fabric, the display offers exceptional durability and longevity. The fabric graphics are printed in high resolution with vibrant, fade-resistant colors. The elegant curved structure of the display creates a dynamic and inviting presentation, drawing attention and enhancing the visual appeal of your booth or exhibit.

### FEATURES

**Enhanced Tubing and Framing** - Upgraded to higher-quality tubing and framing, providing increased strength and durability for long-lasting use.

**Larger Diameter Pipes** - The larger diameter round pipes offer additional stability and support, ensuring the display remains secure and upright.

**Interchangeable Graphics** - Easily update your display with new graphics as needed. The fabric is designed to be removed and replaced effortlessly, making it versatile for different events and promotions.

**Comprehensive Support** - Comes with detailed instructions and customer support to assist with any assembly or usage questions.

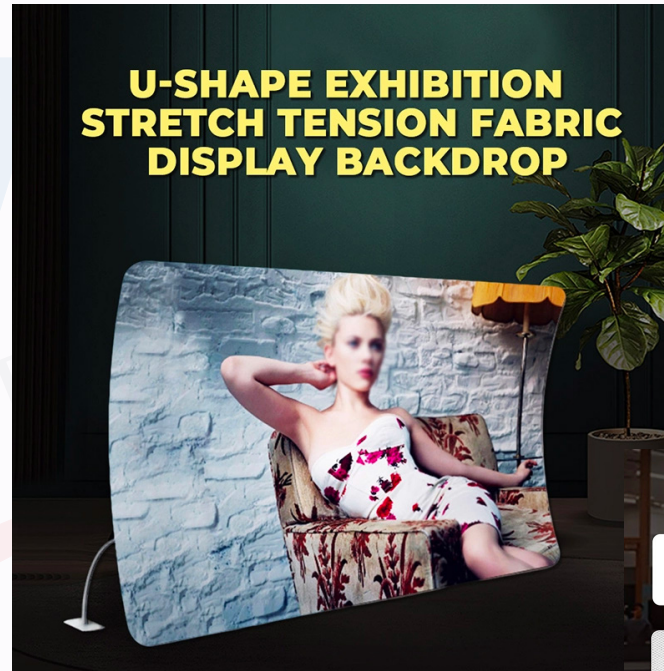

### INSTALLATION TUTORIAL

Simple installation Easy to complete

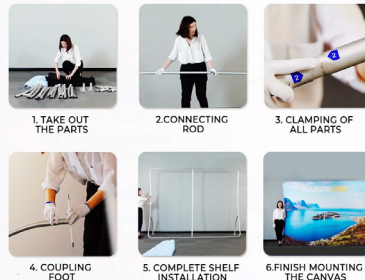

### SIZE DISPLAY

3 sizes to choose from



### FRONT SIDE

### BACK SIDE



SINGLE AND DOUBLE-SIDED PRINTING

# S-Shape Tension Fabric Display

## Unveiling the Ultimate Display Solution: S-Shape Tension Fabric Display

Introducing the U-Shape Exhibition Tension Fabric Display Backdrop, a perfect blend of innovative design and high-quality materials tailored for impactful visual presentations. This display is designed to provide a sleek, modern, and eye-catching backdrop for any event, ensuring your brand stands out.

**SPECIFICATIONS**

Size	Graphic Size(mm)	Frame Size(mm)	Tube Dia	Packing
8ft	2440x2280	2400x2270	32mm	30x30x75cm weight:6.5KG
10f	3040x2280	3000x2270	32mm	30x30x89cm weight:7.5KG
20ft	6000x2280	5960x2270	32mm	38x38x82cm weight:12KG

## DETAILS

### Elevate Your Brand with Vimbo's Upgraded S-Shape Tension Fabric Display

Upgraded to higher-quality tubing and framing for increased strength and durability. The larger diameter round pipes provide additional stability and support for the display. The dimensions of the feet have been enlarged to offer greater stability and strength, ensuring the display remains secure even in high-traffic areas.

Crafted from high-quality tension fabric, the display offers exceptional durability and longevity. The fabric graphics are printed in high resolution with vibrant, fade-resistant colors. The elegant curved structure of the display creates a dynamic and inviting presentation, drawing attention and enhancing the visual appeal of your booth or exhibit.

## FEATURES

**Enhanced Tubing and Framing** - Upgraded to higher-quality tubing and framing, providing increased strength and durability for long-lasting use.

**Larger Diameter Pipes** - The larger diameter round pipes offer additional stability and support, ensuring the display remains secure and upright.

**Interchangeable Graphics** - Easily update your display with new graphics as needed. The fabric is designed to be removed and replaced effortlessly, making it versatile for different events and promotions.

**Comprehensive Support** - Comes with detailed instructions and customer support to assist with any assembly or usage questions.

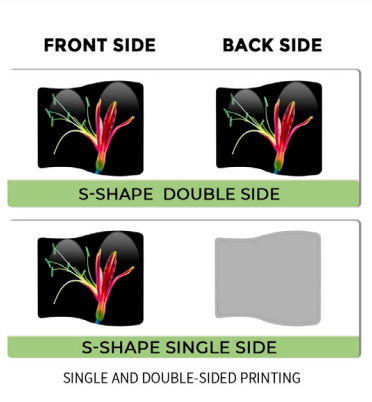
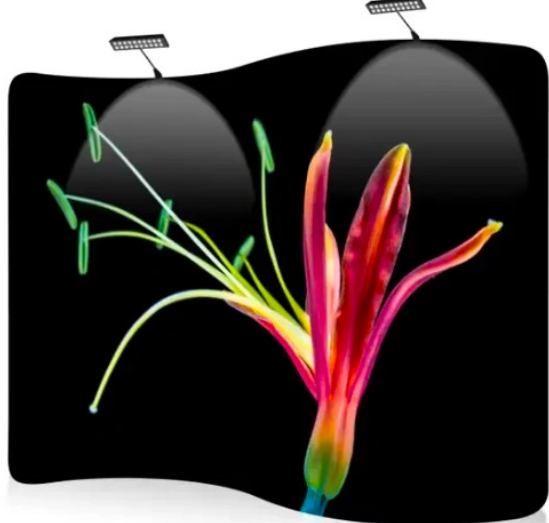

# 3D-Straight Wall-10FT

Attaching such an KZ-T Frame -Tension Fabric Display to your tension fabric wall can create a dynamic, three-dimensional look and will attract more focus to your brand in a trade show, exhibition, conference, and other marketing events. It is a simple and portable solution for a backdrop. You can add left, right, or both panels to your 10FT Straight Tension Fabric Displays.

## SPECIFICATIONS

Display Size	Material	Layer	Printing
244x127cm/96"x50.1"	250g Polyester	Single / Double	Dye Sublimation

## DETAILS

Our KZ-T Frame -Tension Fabric Displays are built with durable and lightweight aluminum tubing with snap-on connectors. And the frame will be broken down to a compact size and labeled for quick and easy assembly. The tension fabric graphics are sewn with a zipper on the bottom, which can not only help secure the graphic on the frame but can also make the graphic snugly fit with no wrinkle. When the frame is ready, you can slip the graphic over the frame like a pillowcase for quick setup.

## FEATURES

**Easy installation** -With snap-on connectors, the panels are easy to set up and take down.

**Wrinkle-free** - Premium elastic fabrics are used to make the graphic. The zipper on the bottom will tighten the stretch fabric to perfectly display your image with no wrinkle.

**Custom design** - You can customize the design of the graphics to fit your tension fabric wall. Or you can also purchase them with our Straight Tension Fabric Displays.

**Long-lasting** - Both the premium fabrics and strong aluminium frame ensure that the panel can be repeatedly used for a long time.

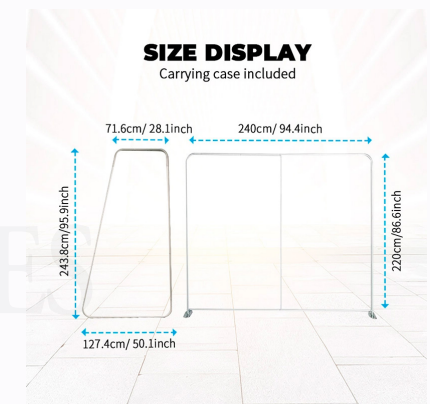
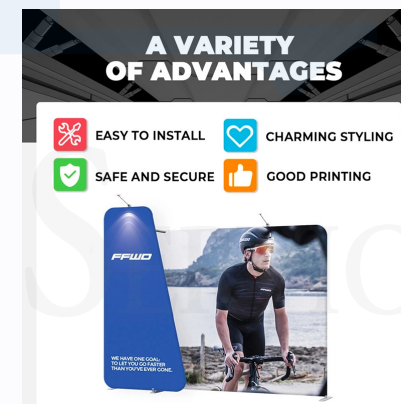
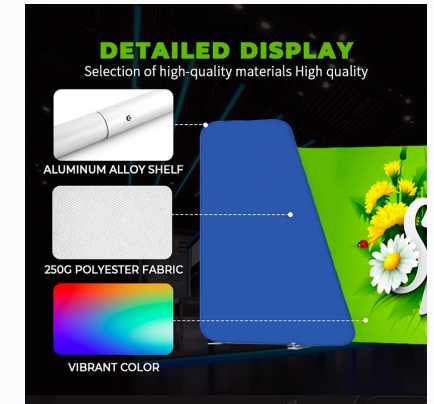

# 3D-Straight Wall-20FT

Attaching such an KZ-T Frame -Tension Fabric Display to your tension fabric wall can create a dynamic, three-dimensional look and will attract more focus to your brand in a trade show, exhibition, conference, and other marketing events. It is a simple and portable solution for a backdrop. You can add left, right, or both panels to your 20FT Straight Tension Fabric Displays.

## SPECIFICATIONS

Display Size	Material	Layer	Printing
244x127cm/96"x50.1"	250g Polyester	Single / Double	Dye Sublimation

## DETAILS

Our KZ-T Frame -Tension Fabric Displays are built with durable and lightweight aluminum tubing with snap-on connectors. And the frame will be broken down to a compact size and labeled for quick and easy assembly. The tension fabric graphics are sewn with a zipper on the bottom, which can not only help secure the graphic on the frame but can also make the graphic snugly fit with no wrinkle. When the frame is ready, you can slip the graphic over the frame like a pillowcase for quick setup.

## FEATURES

**Easy installation** -With snap-on connectors, the panels are easy to set up and take down.

**Wrinkle-free** - Premium elastic fabrics are used to make the graphic. The zipper on the bottom will tighten the stretch fabric to perfectly display your image with no wrinkle.

**Custom design** - You can customize the design of the graphics to fit your tension fabric wall. Or you can also purchase them with our Straight Tension Fabric Displays.

**Long-lasting** - Both the premium fabrics and strong aluminium frame ensure that the panel can be repeatedly used for a long time.

